

03 VÁLVULA DE BOLA MANDO MARIPOSA LG
LG BALL VALVE WITH HANDLE



CONSTRUCCIÓN / MATERIALS

- Cuerpo: **Latón CW617N cromado**
Body: Chrome-plated brass CW617N
- Bola: **Latón cromado pulido**
Ball: Polished chrome-plated brass
- Anillos de cierre: **Teflón (PTFE)**
Seats: Teflon (PTFE)
- Eje: **Latón estampado**
Stem: Patterned brass
- Palanca/Handle: **Aluminio pintado/Coated aluminium**

CONDICIONES DE TRABAJO/OPERATING CONDITIONS

- Temperatura mín./Min. temp.: **-20°C**
- Temperatura máx./Max. temp.: **150°C**
- Presión máxima./Max. pressure: **25 Bar**

APLICACIONES / APPLICATIONS

- Agua caliente y fría, aire comprimido, gasolina, nafta, gasóleo, keroseno, aceites, etc...
Warm and cold water, compressed air, petrol, naphtha, diesel oil, kerosene, oils, etc.

HEMBRA-HEMBRA
FEMALE-FEMALE

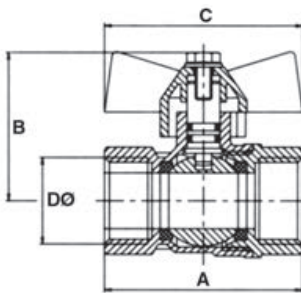

MACHO-HEMBRA
MALE-FEMALE

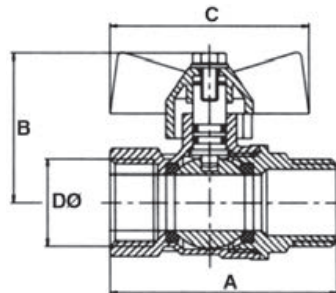

MACHO-HEMBRA RACOR
MALE-FEMALE W/UNION

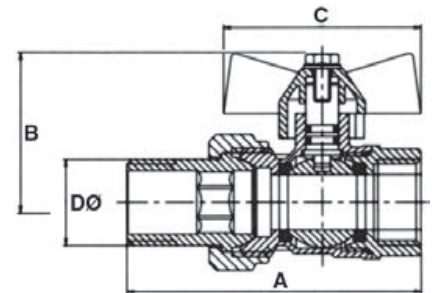

DIMENSIONES / DIMENSIONS

Rosca Thread	3/8"	1/2"	3/4"	1"
A	46	44	51	61
B	35	37	42	48
C	47	48	48	62
DØ	9	14	18	23
Uds. caja Units box	20	8	6	8
Código Code	AA03820	AA03821	AA03822	AA03823

Rosca Thread	3/8"	1/2"	3/4"	1"
A	46	51	61	73
B	35	37	42	48
C	47	48	48	62
DØ	9	14	18	23
Uds. caja Units box	20	8	6	8
Código Code	AA03824	AA03825	AA03826	AA03827

Rosca Thread	1/2"	3/4"	1"
A	75	81	89
B	44	47,5	56
C	48	48	60,5
DØ	14,5	19	24
Uds. caja Units box	10	8	5
Código Code	AA 03 671	AA 03 672	AA 03 673